

FILTERS N900X Series Power Filters

ETS-Lindgren's N900x Power Filters are high performance EMI power filters for use in EMC and Data Center/IT applications as well as any other installation which requires maximum protection from incoming mains interference.



ETS-Lindgren's Model N900X Power Filters are high performance EMI power filters for use in EMC and Data Center/IT applications as well as any other installation which requires maximum protection from incoming mains interference.

Filters in the N900x Series are RF sealed in high quality tin-plated steel cases and include multi stage filtering for significant filtering performance. The load current must return to the dedicated neutral in order to maintain maximum performance. Solid and permanent grounding (earthing) of the filter case is essential for safety reasons and to ensure optimum performance. All ETS-Lindgren power filters are CE marked for compliance with the Low Voltage Directive.

Key Features

- 100 dB Insertion Loss from 9 kHz up to 40 GHz
- Compact, Rugged Construction
- Current Range 16 to 200 Amps
- Fitted with Transient Suppressors as a Standard
- Suitable for use at 400 Hz

Features

Insertion Loss

The N900x range provides 100 dB from 9 kHz to 40 GHz.

Low Power Dissipation

These filters offer very low power dissipation and a case temperature rise of 25°C at full load.

Current Range

The N900x range offers current ratings from 16 to 200 Amps in both Single Phase +N and Three Phase +N.

Voltage Drop

The Voltage drop at full load is below 1%.

Applications

- High Performance Screened Rooms
- Anechoic Chambers
- Reverb Chambers
- Computer Suites/Data Centers
- EMC Applications
- General Purpose High Performance Filtering

Specifications

Electrical Specifications

MODEL	CURRENT Max (Amps)	VOLTAGE Max (Volts)	FREQUENCY (Hz)	LEAKAGE CURRENT MAX. (A)	NUMBER OF LINES	VOLTAGE DROP FULL LOAD PER LINE (% of rated voltage)
N9000	16	250	0 - 400	0.9	2	< 1
N9001	16	250/440	0 - 400	0.06*	4	< 1
N9002	32	250	0 - 400	1.3	2	< 1
N9003	32	250/440	0 - 400	0.085*	4	< 1
N9004	64	250	0 - 400	1.3	2	< 1
N9005	64	250/440	0 - 400	0.085*	4	< 1
N9006	100	250	0 - 400	1.8	2	< 1
N9007	100	250/440	0 - 400	0.120*	4	< 1
N9008	200	250	0 - 400	4.2	2	< 1
N9009	200	250/440	0 - 400	0.280*	4	< 1

Product Charts

N9000X Insertion Loss Performance

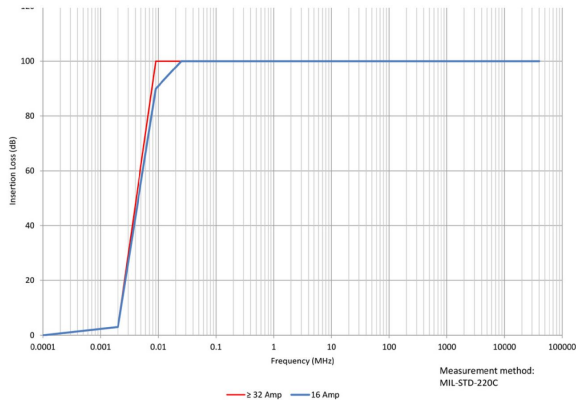

N9000 Power Filter

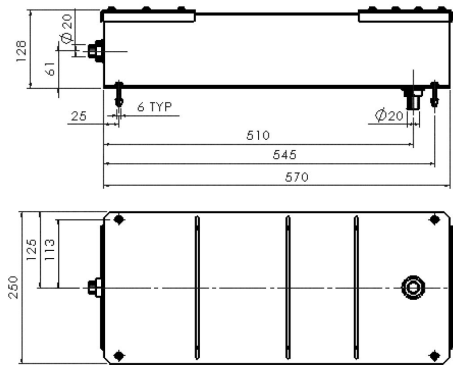

N9001 Power Filter

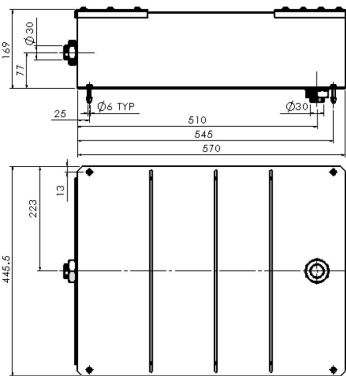

N9002 Power Filter

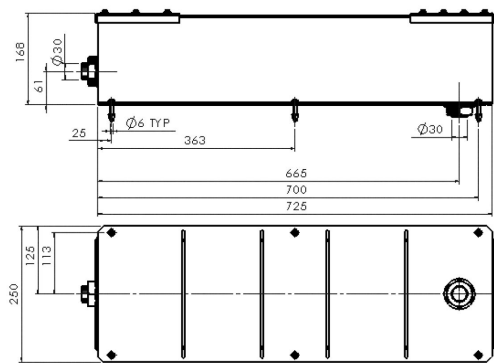

N9003 Power Filter

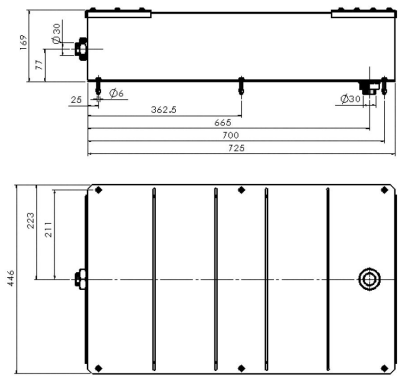

N9004 Power Filter

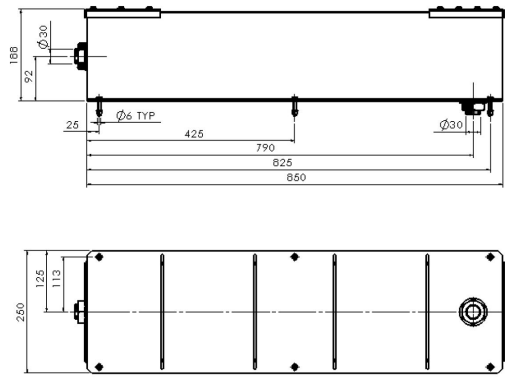

N9005 Power Filter

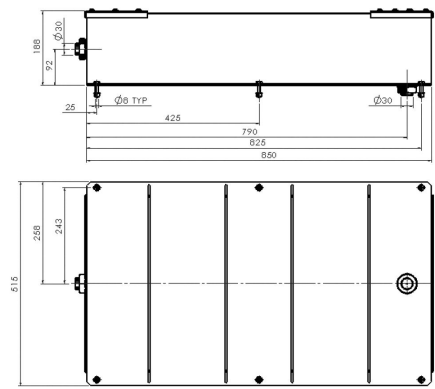

N9006 Power Filter

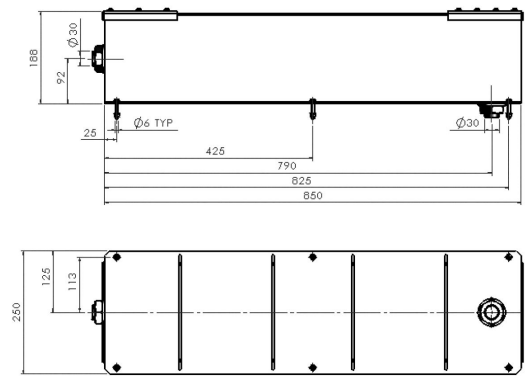

N9007 Power Filter

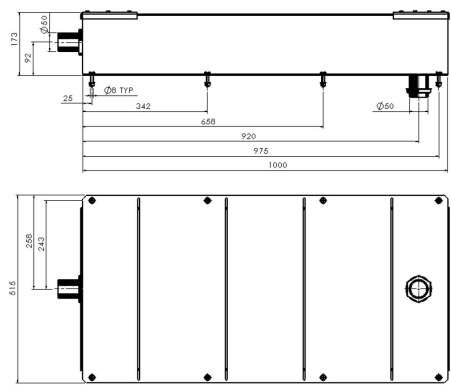

N9008 Power Filter

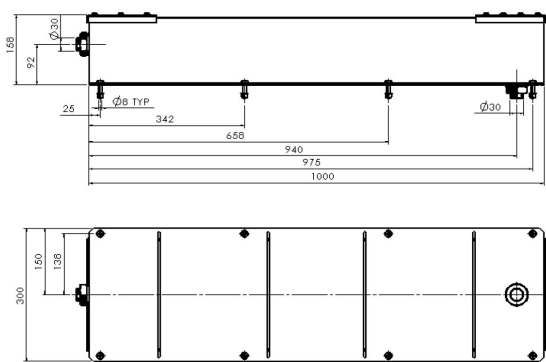

N9009 Power Filter

